

State of South Carolina
 Pursuant to a warrant from
 John Thomas Esq. Com. Sec^y
 dated sixth July 1784, I have
 measured & laid out White George Hite as
 Tract of Five Hundred acres of land
 situated in the Ninety six District
 West of the ancient Boundary line on
 the Swamp of St. Eggers, & Pleasant
 of Enore Rivers; Bounding N.W. on
 Jacob M. Maughton, & all other sides
 vacant, & hath such shape & marks
 as the annexed plat Represents, Survey
 this 11th day of Aug. 1784 Wm. Benson D^y

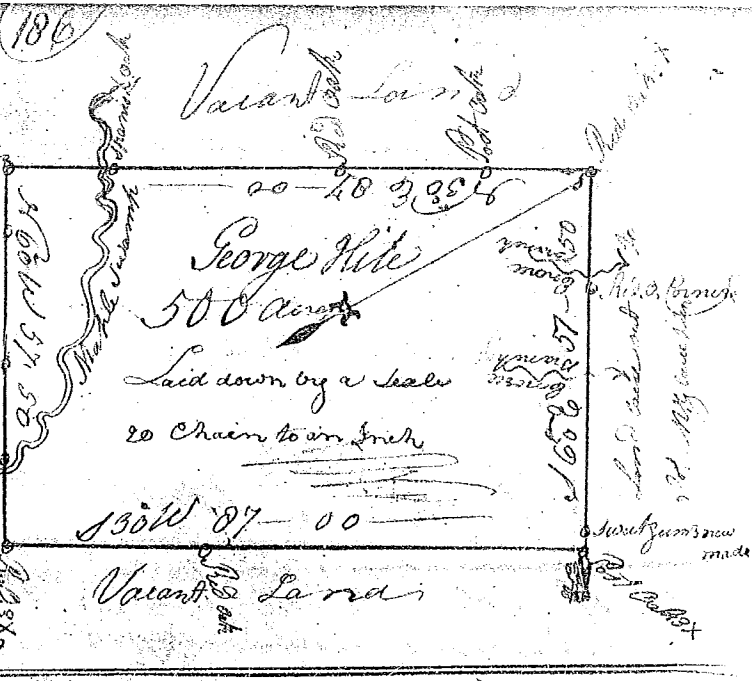

State of South Carolina
 Pursuant to a warrant from
 John Thomas Esq. Commissioner of
 Locations dated 6 July 1784 I have
 measured & laid out unto Mary Moring
 a Tract of five Hundred acres of
 Land, situated in Ninety six District, West
 of the ancient Boundary line, on Saluda
 River, Bounding N.W. on Chat Simmons
 S.W. & E. on John Perry, & on the N.E. on
 of the aforesaid River, including a small
 Island & on all other sides Vacant, and hath such
 shape and marks as the annexed plat Represents
 Survey this 28th July 1784 Wm. Benson D^y

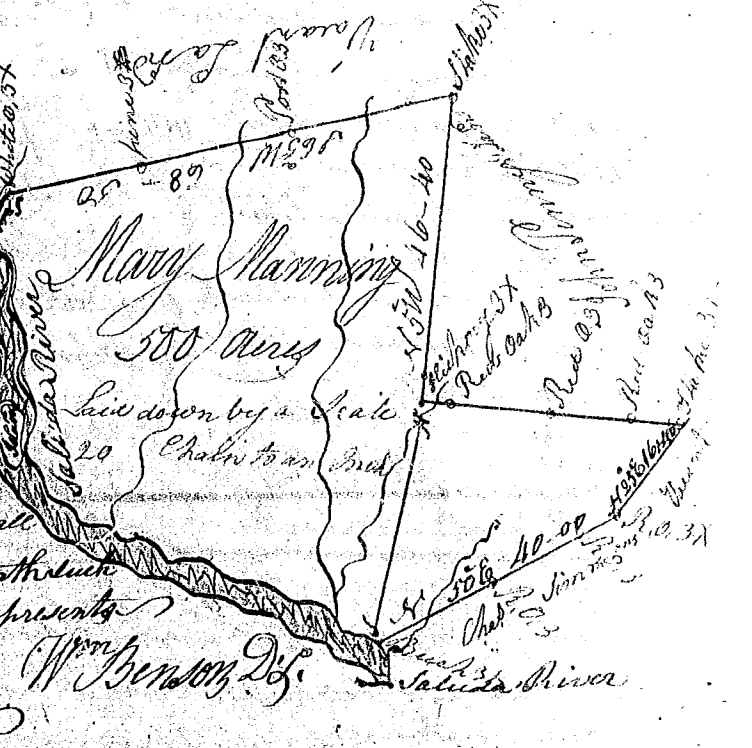

State of S. Carolina
 Pursuant to a warrant from
 John Thomas Esq. Commissioner of Locations dated 6th
 July 1784, I have measured and laid out unto Jacob Obamion
 Hite a tract of five Hundred acres of land
 situated in Ninety six District, West of the ancient Boundary
 on the Swamp of St. Eggers River, Bounding N.W. on
 Bounding N.W. on land laid
 out to George Hite, & all other sides
 Vacant & hath such shape and
 marks as the annexed plat Represents
 Survey this 11th August 1784
 Wm. Benson D^y

